



navarra



COMPETITOR BOOKLET

FIM INTERNATIONAL SIX DAYS OF ENDURO

COMPETITORS' BOOKLET

October 11th-16th, 2016
Circuito de Navarra, Spain



navarra



real federación
motociclista española



COMPETITOR BOOKLET





TABLE OF CONTENTS:

	PAGE
1.- CIRCUIT INFORMATION	4
2.- TRAVEL AGENT	6
3.- FREIGHT	7
4.- PADDOCK	8
5.- CATALOGUE OF SERVICES	10
6.- ELECTRICITY WATER AND TV	17
7.- PADDOCK TIMETABLE	19
8.- MEDICAL SERVICES	20
9.- SHIPMENT ADDRESS	21
10.- MAIN CONTACT	22
11.- INTERESTING LINKS	22
12.- SERVICES FORM	23

1. CIRCUIT INFORMATION

Aerial photo from the Circuito de Navarra



Distances from the main cities:

Pamplona: 63,7 Kms	Zaragoza: 164 Kms	Burdeos: 283,98 Kms
Barcelona: 471 Kms	Bilbao: 165 kms	Oporto: 556,16 Kms
Vitoria: 67,5 Kms	Biarriz: 186 Kms	Logroño: 34,2 Kms
San Sebastian: 142 Kms	Madrid: 356 Kms	Lisboa: 726,02 Kms

The real focus of the Six Days 2016, the modern **Circuito de Navarra**, is located on the outskirts of Los Arcos, on the road A-12. It was inaugurated in June 2010 and it contains a speed, an autocross and Off-road tracks, five parking areas with a total capacity of 8500 vehicles, 32 boxes, press room, assembly hall, museum, commercial area, medical centre, 41K square meter paved paddock, bar, restaurant and terraces.



How to arrive:

The Circuito de Navarra is placed in the new part of the highway called "Autovía del Camino", which stretches from Pamplona to Logroño, between Estella and Viana. Specifically on the crossroads between N-111 and NA-129 (Exit number 58).

The main access road is from exit 58 arriving from Autovía del Camino A-12 (Pamplona-Logroño), towards NA-1110/Sesma.

At the roundabout, you must take the second exit towards the Circuit.

Once in the Industrial park "Polígono La Perguita", go straight ahead until finding a false roundabout.

Once after that, you access the main road to the facilities.

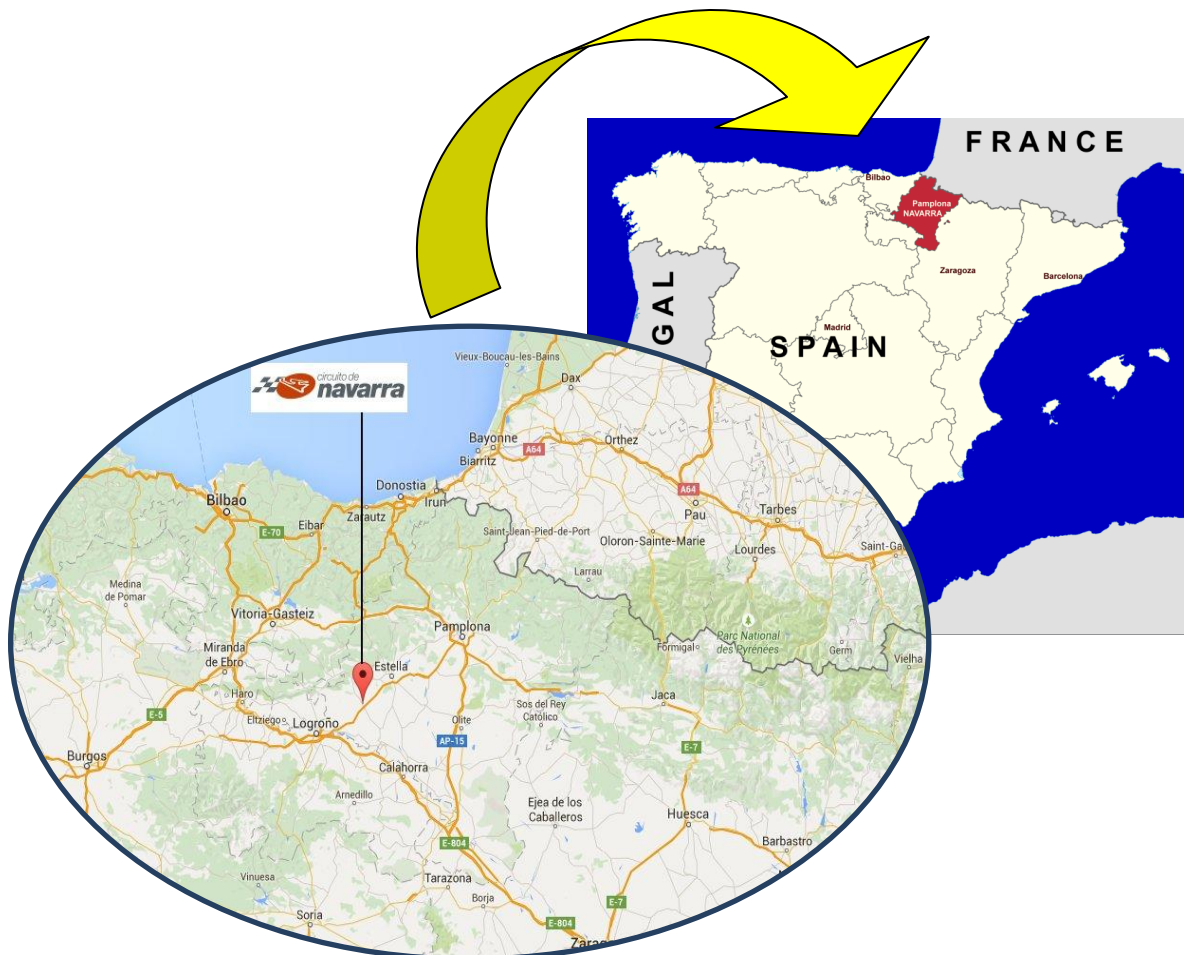



2. TRAVEL AGENT

Altamarca Spain is the official Travel Agent of the FIM ISDE 2016 and controls a capacity of 1200 beds in a 30 kms area around the Circuit.

Altamarca Spain has prepared a document for Teams that includes a wide range of Hotels in different locations and quality standards.

Find the information in the link: <http://www.fim-isde2016.es/en/accomodation/>

Altamarca Spain also books flights and car hire. The aim is to define interesting and competitive prices to make all teams' life easier.

CONTACT PERSON:

Ms. Victoria RAMOS

Phone: 0034 935 100 480

Email: victoria@fim-isde2016.es



3. FREIGHT

AG Sport Events Logistics is a logistics supplier focusing on international teams, specially with Overseas necessities, in order to define the best offers to FIM ISDE 2016 competitors. AG will coordinate logistic and customs operations of all technical material (motorbikes, spares, professional equipment...) that both teams and individual pilots, aimed to realize a safe shipment of all the items and goods needed in order to participate at the event.

ATA Carnet

If your country of origin is included in the attached list, you have to get in contact with your local Chamber of Commerce in order to obtain an ATA CARNET document. You can also check the list of Countries included in the ATA Carnet agreement in the following link:

<http://www.atacarnet.com/carnet-countries>

If your Country of origin is not included in the list of ATA Carnet Countries, you shall import the entire material needed for the race through a Temporary Import.

The material needed in order to participate at the ISDE 2016, can be shipped in two different ways, depending on your preferences:

By air: **MADRID BARAJAS INTERNATIONAL AIRPORT (SPAIN)**

By sea: **VALENCIA PORT (SPAIN)**

Once your material will be at MADRID BARAJAS INTERNATIONAL AIRPORT or VALENCIA PORT, AG will take care to handle the import Customs clearing in Spain and deliver it to the event location. AG will also take care of the re-export Customs clearing from Spain and the shipment of your material back to your Country after the event.

Please note: no later than **15th of July** for Sea shipments and no later than **06th of September** for Air shipments.

Ag Sport Events Logistics recommends using proper crates.

AG Sport Events Logistics will not be liable for any damages caused by insufficient packing.

More information about Freight in the following link: <http://www.fim-isde2016.es/en/freight/>

CONTACT PERSON:

Ms. Priscilla FILIPPINI – Freight:

Phone: 0034 902 266 664
0034 963 312 646

Email: freight@fim-isde2016.es



4. PADDOCK

PADDOCK RULES:

- Passes will be issued by the Organization
- Not permitted to drive along the facilities without passes provided by the organization
- Not permitted to drive recklessly along the paddock, i.e. either driving at a high speed, or not giving way to pedestrians, or surpass the legally allowed velocity.
- Not permitted to drive cars non- according to the technical legislation
- Not permitted to exchange passes and accreditations
- Not permitted the access of pets
- It is forbidden to cook at the pits and working area

Scoters are no longer allowed in the Working Paddock.

Only dedicated vehicles for tyres & technical equipment will be allowed (no quads, no golf carts, no light trucks)

Please make sure to park on a correct position & area.

For safety reasons, small motorized vehicles such as pocket bikes, motorized skate-boards & push scooters or any customized vehicles are forbidden in the entire circuit.

There will not be Paddock B during FIM ISDE 2016.

Thank you in advance for following these basic safety rules which will help the organization to keep everybody safe

USE OF CIRCUIT FACILITIES

- It is absolutely forbidden to paint, drill and in general to misuse the facilities (paddock, walls, installations, etc.).
- The organization may provide concrete blocks to the teams to fix tents
- It is compulsory to use plastic or similar material covers for the floor within the working tents
- It is the team responsibility to remove used tyres once the event is finished and deposit the oils, rags, or spare parts inside the bins provided for that use



Paddock Schedule:

Paddock opening hours

Thursday, October 6th:		12'00 - 21'00h.
Friday, October 7th:		09'00 - 21'00h.
Saturday, October 8th:		09'00 - 21'00h.
Sunday, October 9th:		09'00 - 21'00h.
Monday, October 10th:		09'00 - 21'00h.
Tuesday, October 11th	DAY 1:	05'30 - 22'00h.
Wednesday, October 12th	DAY 2:	05'30 - 22'00h.
Thursday, October 13th	DAY 3:	05'30 - 22'00h.
Friday, October 14th	DAY 4:	05'30 - 22'00h.
Saturday, October 15th	DAY 5:	05'30 - 22'00h.
Sunday, October 16th	DAY 6:	05'30 - 22'00h.
Monday, October 17th:		09'00 - 14'00h.



5. CATALOGUE OF SERVICES:

The services contained in this catalogue have to be proceeded with **Altamarca Spain**.
Please contact:

CONTACT PERSON:

Ms. Victoria RAMOS:

Phone: 0034 935 100 480

Email: victoria@fim-isde2016.es

During the event you will be able to book the services in the Paddock General Office.

For further information please contact Altamarca Spain.

HOSPITALITY / CATERING FOR TEAMS:

- Open from Thursday 6th October 2016.
- Buffet menu and possibility to take away
- Open: 12 – 21h.
- Price: 20€ VAT incl.
- Price Take away: 20€ IVA incl.

INTERNET:

The Organization will propose two Internet connection ways:

- Guest Connection: FREE
- Professional Connection: 10M/1M 575,00 € VAT incl. for the whole event (6-17th October)
 - The internet supplier companies in Spain guarantees a minimum of 10%



navarra



CIRCUIT GARAGES (BOXES):

- 25 Modern garages connected between them if needed available for Teams
- Using them makes overall freight costs cheaper, as containers do not need to stay at the Circuit during all the Event
- In the garages also we have two inside closet electrical and one outside (in the side of the Paddock) of 40 amperes each one
- Measures: Total Surface: 99'35 sqm (6'5 width x 14'8 length x 4'5 height)
- WC inside the Box
- The price of each box is: 200€ VAT incl./per day

BOXES LAYOUT

COMPETITOR BOOKLET

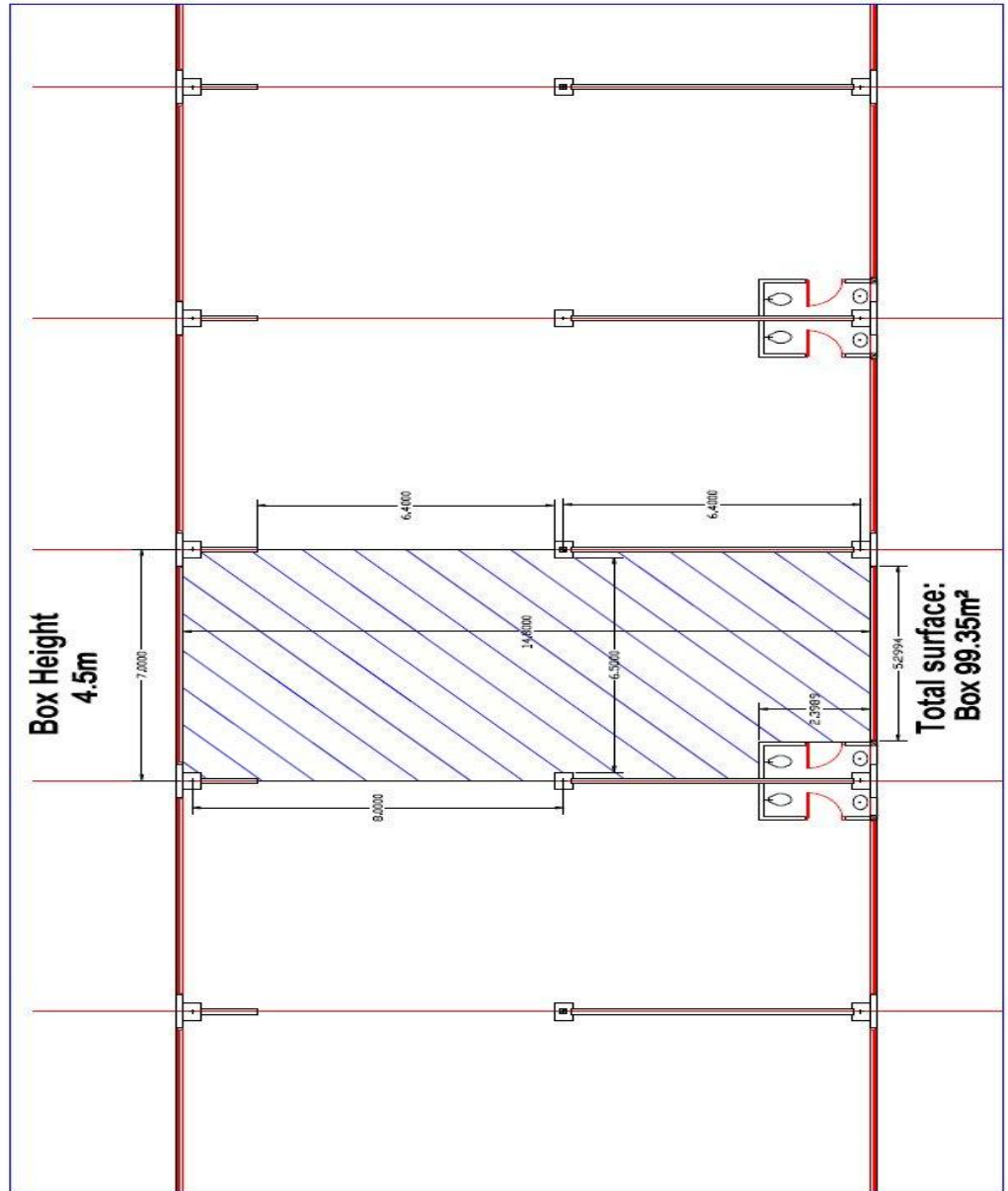

Paddock Resources

COMPETITOR BOOKLET

circuito de navarra

Paddock





PARKING FOR TOWS:

- Available secure parking close to the paddock
- Price: 50€ VAT incl. For whole event (from October 6th – to 17th)

PARKING FOR MOTORHOMES:

- Located inside the circuit at 200m. to the Paddock
- The price is: 15€ VAT Incl./ per day
- Electrical connection available

WAITING AREA FOR TRUCKS:

- Free service available for trucks
- The teams that may appear with several days of anticipation in the circuit, will have to rent a place in the waiting area for trucks :
 - This service is without cost up to the week before the day of entry: from 28th September – to 5th October
 - Everything exceeding this date, will have a cost of 15€ VAT incl./ per day
 - Please note, that the order of entry to the Circuit will be defined by the organization

FUEL STATION:

- AVIA fuel station (24h.) located inside the Paddock Area
- Another AVIA fuel station located 1km. from the Circuit

SECURITY:

- It will not be permitted to operate at the Circuit during FIM ISDE with an external Security Company.
- If anyone will need to have extra security in any of their locations, please contact Altamarca Spain



circuito de
navarra



fim federación
motociclista española



FORKLIFT HIRE:

- The organization can provide forklifts to rent
- Price: 60€ VAT incl./ hour (The service includes a forklift operator)

MADFORM MESSAGES:

- Pack for 6 days (1 massage per day/45min.): 400€ VAT incl. **(For bookings up to September 8th)**
- Price for 6 massages: 460€ VAT incl.
- 1 massage reserved on site: 85€ VAT incl.



MULTIBRAND ASSISTANCE SERVICE:



COMPETITOR BOOKLET

For national teams, amateurs and Vintage Trophy riders, for all bike brands

This service Includes:

- Petrol at all time checks with service
- Motorex oil & products for bike care
- Basic tools, stands and set up of the service point
- Food & beverages at all time checks
- Logistic, mechanic and race support by professional staff according to FIM rules
- Storage of materials, spare parts and tyres at Paddock time check
- Usage of Rabaconda tools for tyre change and special purchase offers
- “Change your tyre in 3 minutes” pre-race course provided by Rabaconda staff
- Buffet meal after race at the Circuito de Navarra facilities

Price per rider ISDE..... 990€ incl Tax

Price per rider Vintage Trophy (only 5th & 6th race days) 190€ incl Tax

Service available from race day 1 to race day 6

Non refundable in case of no show or retirement

Booking before September 1st at victoria@fim-isde2016.es

6. ELECTRICITY, WATER AND TV

- The Electrical power supplied has the following characteristics:
 - 40 Amps with 380v and 220v 3 phase
 - The organization may sell global plug system for EU plugs ensure that you can always make use of your own electrical appliances with 1 phase
 - 16 CEE Form to Schuko: 50€ VAT Incl.
 - 32 A – 5P to CEE Form: 90€ VAT Incl.
- Also, each tower contains the following: water, outlet and capture of TV

FACILITIES SCHUKO SOCKETS

						
North America Grounded NEMA 5-15	Japan Non-grounded JIS C 8303	Europe German style CEE7/4 Schuko	Europe French style Schuko	Europe/Russia Non-grounded CEE7/16 Europlug	Great Britain Grounded BS-1363	Great Britain "Shaver socket" BS-4573
						
Australia/China Grounded AS-3112	Italy Grounded CEI 23-16	Switzerland Grounded SEV-1011	Denmark Grounded SRAF 1962/DB	Israel Grounded SI 32 (IS 16A-R)	India Grounded BS-546 "Small"	South Africa Grounded BS-546 "Large"



FACILITIES CEE FORM CONNECTORS

COMPETITOR BOOKLET



**GETAG GEEform 32Amp 5PINS
 3 PHASES + NEUTRAL + GROUND**

**GETAG GEEform 16Amp 3PINS
 1 PHASE + NEUTRAL + GROUND**

CONTACT PERSON:

**Mr. Fernando Arandiga –
 Paddock Manager:**

Phone: 0034 722 567 272

Email: paddock@fim-isde2016.es



7. TIMETABLE

Thursday 6 October

12.00 – 21.00

Paddock Opening hours

Friday 7 October

Opening of Classic Expo, Commercial Area
and VIP Area openings

Saturday 8 October

09.00 – 19:00

Administrative Inspection

13.00 – 19.00

Technical Inspection

Sunday 9 October

13.00

Trophy Teams Photo Session

12.00 – 19.00

Media Accreditation

18.00 – 20.00

Opening Ceremony in Pamplona

Monday 10 October

09:00 – 17.00

Technical Inspection

Tuesday 11 October. DAY 1

08.00

Start - First Rider

15.00

Arrival - First Rider

Wednesday 12 October. DAY 2

08.00

Start - First Rider

15.00

Arrival - First Rider

Thursday 13 October. DAY 3

08.00

Start - First Rider

15.00

Arrival - First Rider

Friday 14 October. DAY 4

08.00

Start - First Rider

15.00

Arrival - First Rider

17.00

Acceleration Cat. Vintage + Parc Fermé

Saturday 15 October. DAY 5

08.00

Start - First Rider + VINTAGE Category

15.00

Arrival - First Rider

Sunday 16 October. DAY 6

08.00

Start - First Rider

10.00

Motocross Final race at Circuito de Navarra

15.00

Prize Giving Ceremony at Circuito de Navarra



8. MEDICAL EMERGENCIES

Emergency Number: 112

Closest Hospitals to the Circuit:

Navarra:

- Complejo Hospitalario de Navarra (59 km. from Los Arcos). It has all medical specialties
- Clínica Universidad de Navarra (59 km. from Los Arcos). It has all medical specialties
- Hospital García Orcoyen (23 km. from Los Arcos). Regional hospital

La Rioja:

- Hospital San Pedro (32 km. from Los Arcos). All specialties except neurosurgery



circuito de
navarra



federación
motociclista española



9. SHIPMENT ADDRESS

- For specific material shipment during the event (not related to freight. Only Courier):
 - Circuito de Navarra
Malvasía, 5
31210 Los Arcos (Navarra)
- Please note that all the shipments must be identified with following text: **ISDE**
- Business hours of reception: 9 – 18h. (from Monday to Friday)



10. MAIN CONTACT FIM ISDE 2016

Paddock Manager:

Fernando ARANDIGA

0034 722 567 272

E-mail: paddock@fim-isde2016.es

11. INTERESTING LINKS

FIM Branding Manual:

<http://www.fim-isde2016.es/en/branding-manual/>

Logo FIM ISDE:

https://www.dropbox.com/s/cwdm0e5urvki1uo/ISDE-2016_V3_t.png?dl=0

https://www.dropbox.com/s/c2yaw35gxe7isqx/Logo_ISDE_2016_Horizontal.png?dl=0



12. SERVICES FORM (compulsory to be filled and send back)

CUSTOMER DATA:			
TEAM/ Name:			
Address:		Town:	
Post Code:		Country:	
Admin contact:	Name:	Email:	Mobile:
VAT number:			
Technical on site contact:	Name:	Email:	Mobile:

SERVICES:

	Quantity	Price
Catering tickets: <input type="checkbox"/>	0	20,00€ / ticket
Internet 10M/1M: <input type="checkbox"/>	0	575,00€ / all event
Boxes: <input type="checkbox"/>	0	200,00€ / per day
Parking for tows: <input type="checkbox"/>	0	50,00€ / all event
Parking for Motorhomes: <input type="checkbox"/>	0	15,00€ / per day
Waiting area for trucks: <input type="checkbox"/>	0	15,00€ / per day
Security: <input type="checkbox"/>	0	28,75€ / hour
Forklifts: <input type="checkbox"/>	0	60,00€ / hour
Massages: <input type="checkbox"/>	0	460€ / pack
Multibrand assistance service pack: <input type="checkbox"/>	0	990,00€ / each
Global plug system: <input type="checkbox"/>	0	Option 1: 16 CEE Form to Schuko: <input type="checkbox"/>
Option 2: 32 A to CEE Form: <input type="checkbox"/>		50,00€ / Option 1 90,00€ / Option 2

Prices VAT included (This is a prepaid service, only paid services will be delivered on site -with proof of payment)

NO SERVICES REQUIRED:



Paddock Necessities:

NUMBER OF TRUCKS:

Type of truck /measures/ slides/ power supply needed:

- Tractor Unit + Trailer:
- Van + Tent:
- Car + Trailer + Tent:
- Container:

NUMBER OF MOTORHOMES:

Type of Motorhome /measures/ power supply needed:

NUMBER OF WORKING TENTS:

Type /measures/ power supply needed:

HOSPITALITY:

Type /measures/ power supply needed:



WORKING AREA NECESSITIES:

Type /measures:

SERVICE TIME CHECK NECESSITIES:

Type /measures:

OTHER REQUIREMENTS:

Four empty horizontal lines for text entry.

Name & signature

Date